



markem·imaje

a DOVER company



Print and apply labeling systems

2200 Pallet

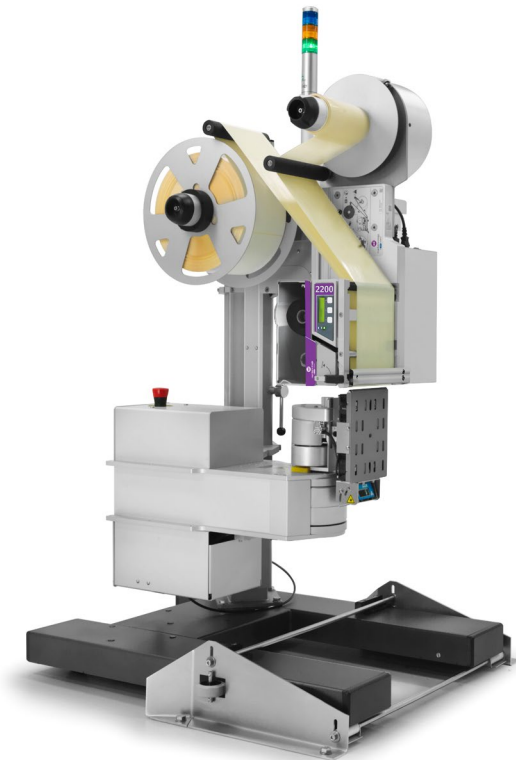

Markem-Imaje's commitment: to deliver best in class efficiency

The 2200 Pallet builds on a proven concept providing reliability, efficiency and ease of use in demanding 24/7 environments. It offers faultless traceability with optional inline barcode validation and provides high-performance printing for single or dual label applications. This solution fully meets GS1 standards for pallet labeling, enabling seamless end-to-end supply chain traceability.

With Markem-Imaje **CoLOS**® software package dedicated to pallet management, each pallet is assigned a unique code that allows for tracking from the moment it leaves the production line until it reaches its final destination.

Product features

Higher operational effectiveness

- Safe and easy to use, competent operation can be achieved with less than 5 minutes of training.
- Longer media lengths for extended operation and synchronized media reloading. Replenish label and ribbon rolls in less than 40 seconds.
- Automatic shut-off feature for enhanced operator safety and quick restart.

Unmatched reliability

- Compliant ANSI grade A/B codes even at the highest application speed. An integrated barcode scanner ensures that 100% of cases leave the factory with a readable barcode.
- Each unique pallet label can be identified and tracked at every step of its journey, from when it leaves the factory to its final destination.
- Unique compact design and robust swing arm applicator makes it the perfect long-term investment.
- High-performance non-stick label pad and contact parts for easy to clean, uncomplicated operation.

High-performance printing

- 1 or 2-side pallet labeling at speeds up to 120 pallets per hour.
- Maximized productivity with proven, accurate adjacent side pallet labeling.
- Dual RISC processors, supported by a dedicated ultra fast co-processor, deliver efficient performance.
- **Ultraply** labels and ribbons guarantee print quality and long printhead life.

2200 Pallet Specifications

Print Features

Print methods: Thermal transfer or direct thermal (selectable on the same print unit)
Built-in real-time clock
10 individual programmable counters

Print engines:

2620: 168 mm, 200 dpi (8 dots per mm)
2630: 162 mm, 300 dpi (12 dots per mm)

Maximum print speed: 300 mm/s

Swing arm for one and two adjacent side applications

Label application time cycle:

- Single linear movement: 7 s
- Single side movement: 10 s
- Two adjacent side movement: 20 s

Fonts: 16 smooth scalable fonts available
TrueType font downloadable
Support for Unicode fonts

Graphic features: BMP, WMF, PCX, PNG, ICO, GIF, TIFF and JPEG
GS1 compliant barcodes as well as all major linear and 2D barcodes supported

Media Specifications

Media types: Die-cut self-adhesive labels
Label stock outside wound as standard

Standard label size: DIN A5 148 x 210 mm

Maximum label width: 178 mm

Maximum label roll: 350 mm

Inner core: 76 mm

Inside wound thermal transfer ribbon

Ink ribbon length: 660 m

Ribbon core: 25 mm

Best results with **Ultraply** consumables range

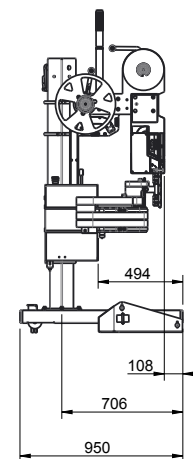
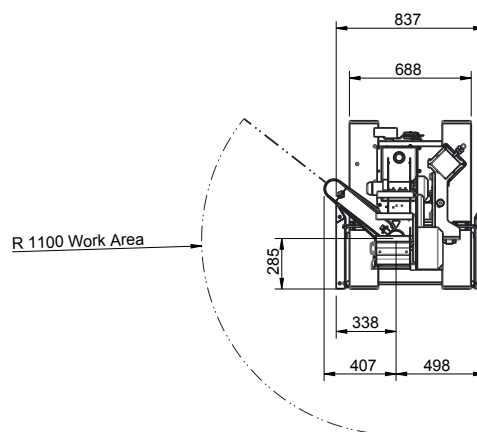
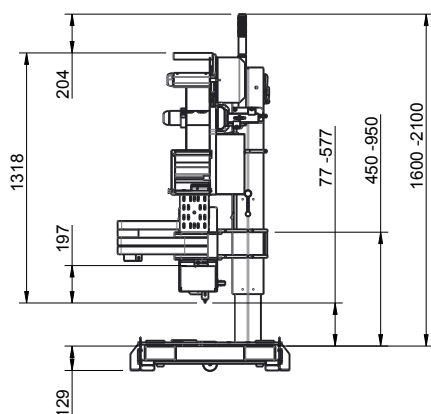

Operating Characteristics

Simple on-board user interface:

Graphic display and machine status in local languages
Start, stop, pause or print
Local label selection
Machine back-up/restore or cloning
Built-in safety feature: Automatic air shut-off when applicator hits obstacle
Remote and machine emergency stop buttons

Communication interface:

2 x In via Opto
5 x Out via relay (24 VDC)
High-speed RS-232, 300 – 115 200 bps
Ethernet 10/100 (R Telnet, FTP, web server)
USB support for back-up/restore and label upload
Compatible with Weihenstephan standard
Programmable re-apply sequence or fault after barcode failed read

Environment:

Temperature range: 0°C to 45°C
Humidity: 20% to 85% non-condensing
Power requirements: 110/240 VAC; 50/60 Hz
Power consumption below 60 watts at maximum throughput.
Air supply: 6 bars, dry and clean
System including stand >85% recyclable

Applicators Range

- Left- and right-applicator versions (frontside, backside)
- Wipe 700 applicator for fast non-stop pallet labeling
- Pallet applicator for durable 300 dpi print quality in harsh environments and for heavy usage.

For more information on case and pallet solutions please visit www.markem-imaje.com

Options and Accessories

Inside wound label kit
Expanded memory SD card slot
Scalable and international fonts
Three-color-status beacon
Barcode readers
Floor stand and docking station

Services and Support

Markem-Imaje offers the sector's most comprehensive array of digital, remote and on-site services to further empower our customers to maximize the return on their investment in our solutions. Designed to satisfy Industry 4.0 demands for increased customization and remote 24/7 digital assistance to reduce downtime, the portfolio of maintenance services is tailored according to user needs, skills and available resources.

Software

CoLOS® Software & Packaging Intelligence Solutions: Modular solutions for message creation/code management and control, integration with ERPs/MES/WMS.

CoLOS® Base, **CoLOS®** Line, **CoLOS®** Line Terminal, **CoLOS®** Factory and **CoLOS®** Pallet



markem·imaje

a **DOVER** company